



भारतीय अन्तर्देशीय जलमार्ग प्राधिकरण
INLAND WATERWAYS AUTHORITY OF INDIA
(पत्तन पोत परिवहन और जलमार्ग मंत्रालय, भारत सरकार)



क्षेत्रीय कार्यालय:

गायघाट, पो0-गुलजारबाग
पटना- 800007
दूरभाष : 0612-2310026
फैक्स: 0612-2310029

(Ministry of Ports, Shipping and Waterways)
(Govt. of India)

Regional Office:

Gaighat, P. O. – Gulzarbagh,
Patna – 800007
Phone/Tele fax :0612-2310029
E-mail: iwaiptn@rediffmail.com

File No-12-IWAI/ENGG/P (02)/2024-25/1126

Date: 23.10.2024

NOTICE INVITING QUOTATION (NIQ)

Sub: NIQ for Supply/Procurement and repair & fitting of elast coupling of CSD Yamuna at Gaighat, Patna-reg.

Inland Waterways Authority of India (IWAI) invites sealed quotations from experienced resourceful and reputed firm/contractors for supply/procurement and repair & fitting of elast coupling multi-mont sella type MMF100 for alternator coupling of auxiliary engine CAT make 3412 of CSD Yamuna at Gaighat, Patna as per sample/drawing (Drawing Enclosed). The detail of BOQ is enclosed as Annex-1.

The terms and conditions are as under: -

1. The firm shall be submitted the copy of PAN Card, GST Registration, Cancel cheque and firm registration certificate.
2. The work shall be completed within 07 (Seven days) from the date of receipt of work order.
3. Payments shall be released on submission of final bill along with receipt of challan within 15 days after deduction of statutory dues if any and duly certification by concern officials/officers.
4. The material shall be supplied as per sample/drawing (Drawing Enclosed).
5. The standard guarantee/warranty shall be applicable as per manufacturing norms/company rules and guarantee/warranty card/documents shall be submitted along with bill/invoice to this office.
6. The rates shall be written both in words and figures.
7. Price bid shall be submitted in the format attached at Annexure-I which should be duly signed and stamped by the supplier and without any deviation/condition.
8. Inland Waterways Authority of India (IWAI) reserves the right to accept or cancel any quotations without assigning any reason or any prior notices.

All the quotationer shall be addressed to the Director, IWAI, Gaighat, Patna 800007 in a sealed cover. Quotations will be received upto at 15:00 hrs on 29.10.2024 and will be opened on the same day at 15:30 hrs by the officers of the IWAI in the presence of the representative of quotationer who choose to attend.

5.10.2024
(V. Murugesan)

Director, IWAI, RO, Patna
Email: vmurugesan.iwai@nic.in

Encl: - As stated above.

Copy to :

1. IWAI Notice board and Uploading IWAI Website

मुख्य कार्यालय :ए-13, सेक्टर-1, नोयडा,
जिला-गौतमबुद्ध नगर(उ.प्र.)
फोन : 0120-2544036/4009/4041/2521664

HEAD OFFICE: A-13, SECTOR-1, NOIDA,
GautamBudh Nagar (U.P.): 201301
E-mail : iwainor@nic.in website www.iwai.nic.in

BOQ for Supply/procurement and repair & fitting of elast coupling of CSD Yamuna at Gaighat, Patna

Sl.No.	Description of Work	Unit	Qty.	Rate	Amount
1	Supply/procurement and repair & fitting of elast coupling multi-mont sella type MMF100 for alternator coupling of auxiliary engine CAT make 3412 of CSD Yamuna at Gaighat, Patna as per sample/ drawing (Drawing Enclosed).				
	Labour charges	Comp. Job	1		
Note:	1. Provision for Cost of spares (actual + 10% basis)				
	2. Excluding GST as applicable.				

Seal with signature of bidder

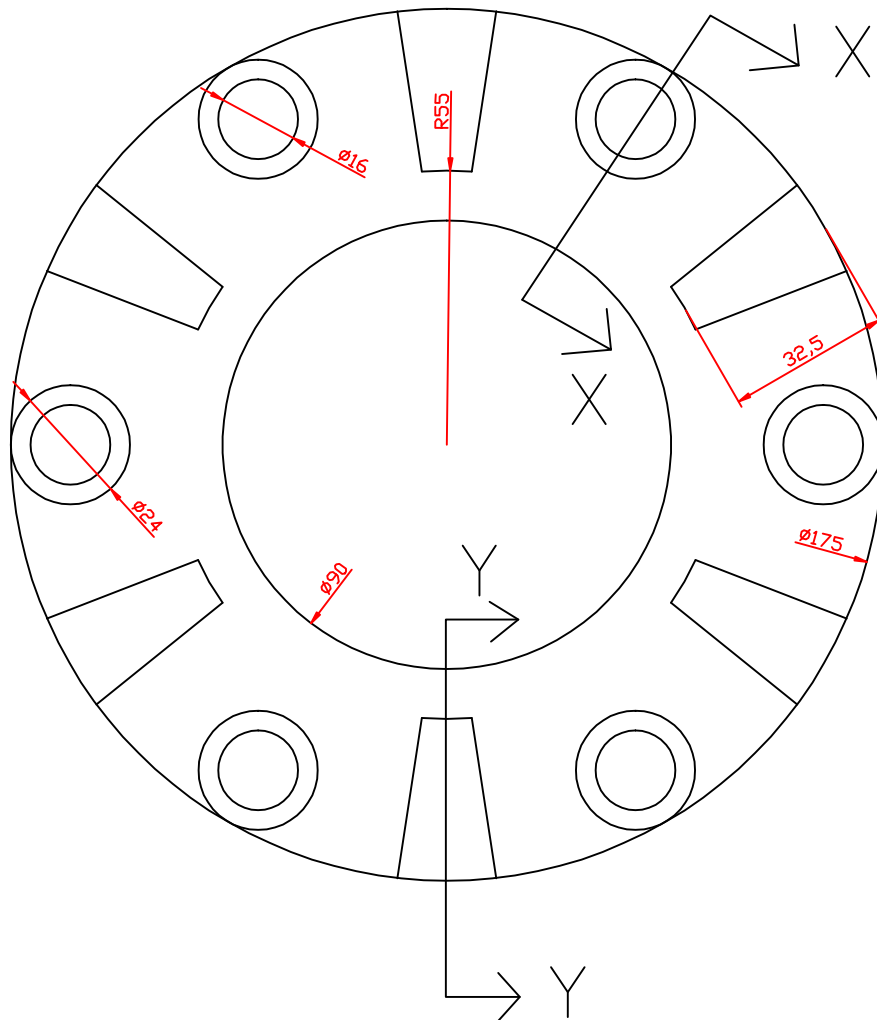

Female top view (Engine side)

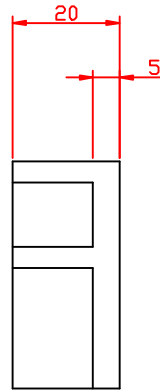

sectional view at
X-X (Engine side)

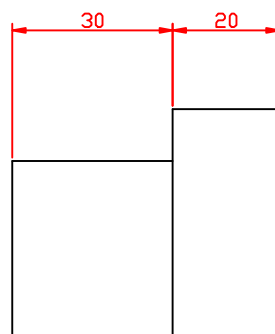

Sectional view at
Y-Y (Engine side)

KEY Tightning Hole

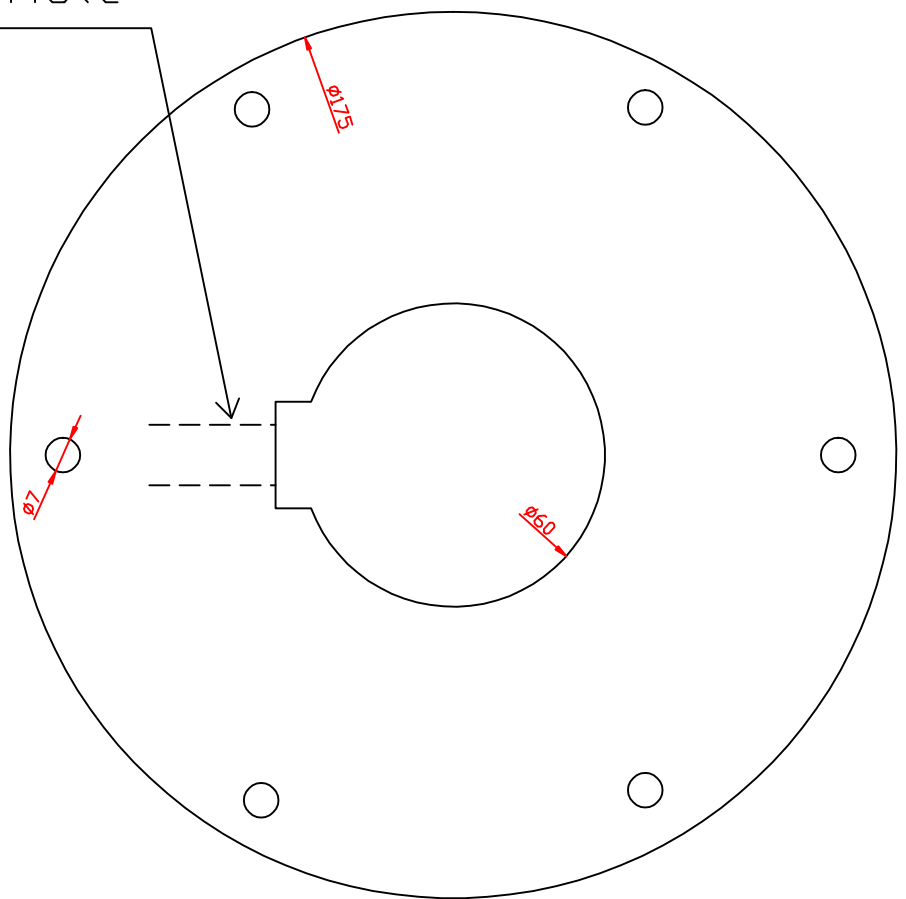

Male bottom view

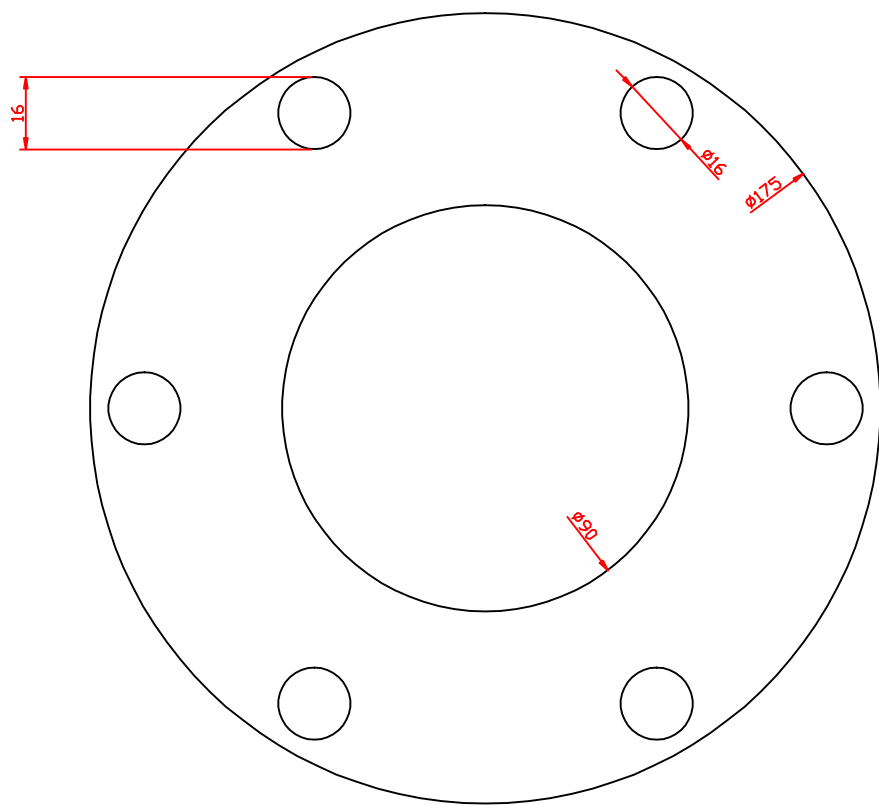

Female bottom view(Engine side)

KEY Tightning Hole

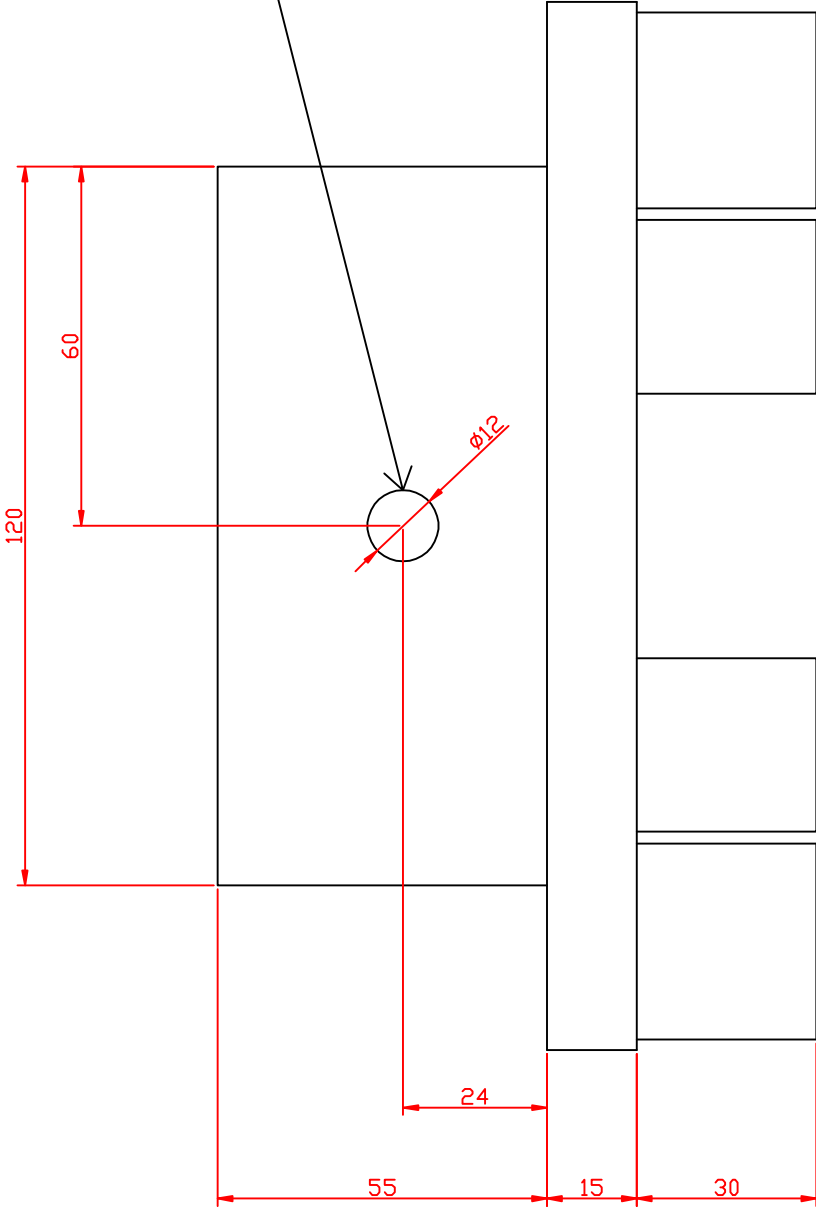

Male side view

KEY Tightning Hole

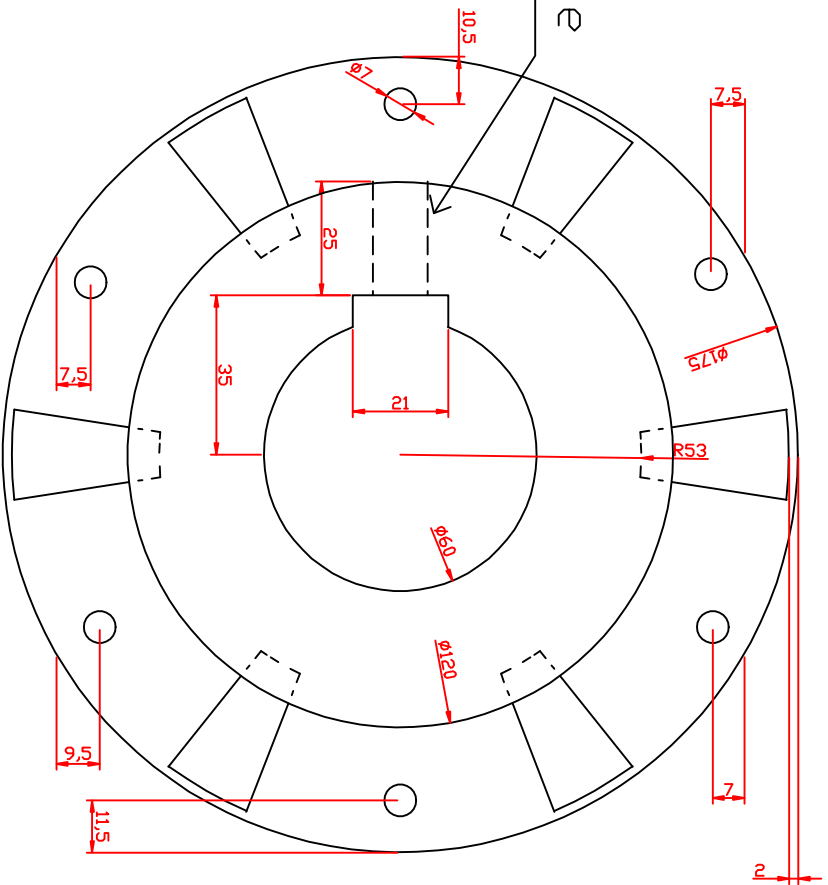

Male top view

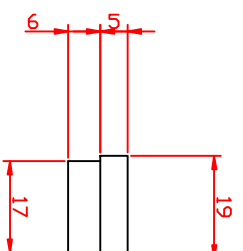

KEY top view

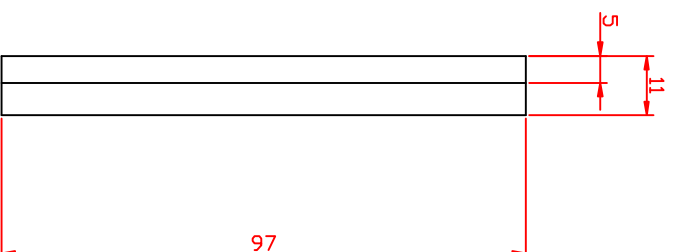

KEY Front view

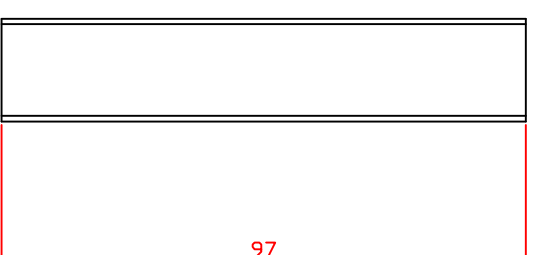

KEY Front view

-W66

Elast. Coupling

Multimont Sella type MMS NF100

$$J_{tot} = 0,158 \text{ kg m}^2$$

$$\text{Weight} = 11,8 \text{ kg}$$

Generator

Ansaldo type MXM

Output 52 KVA

$$J = 0,521 \text{ kg m}^2$$

$$\text{Weight} : 300 \text{ kg}$$

pillar 3412 DI-T

7 KW 1500 r.p.m.

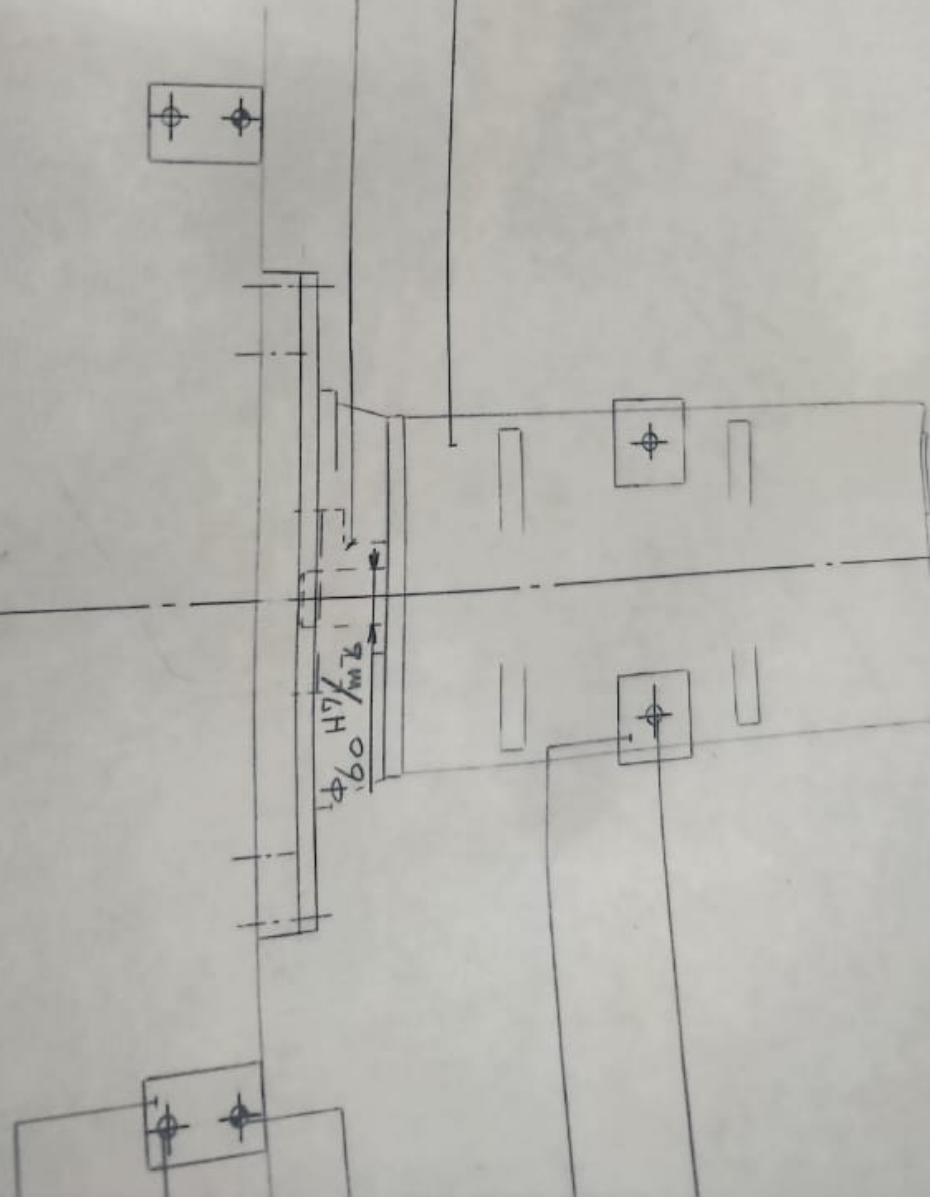

















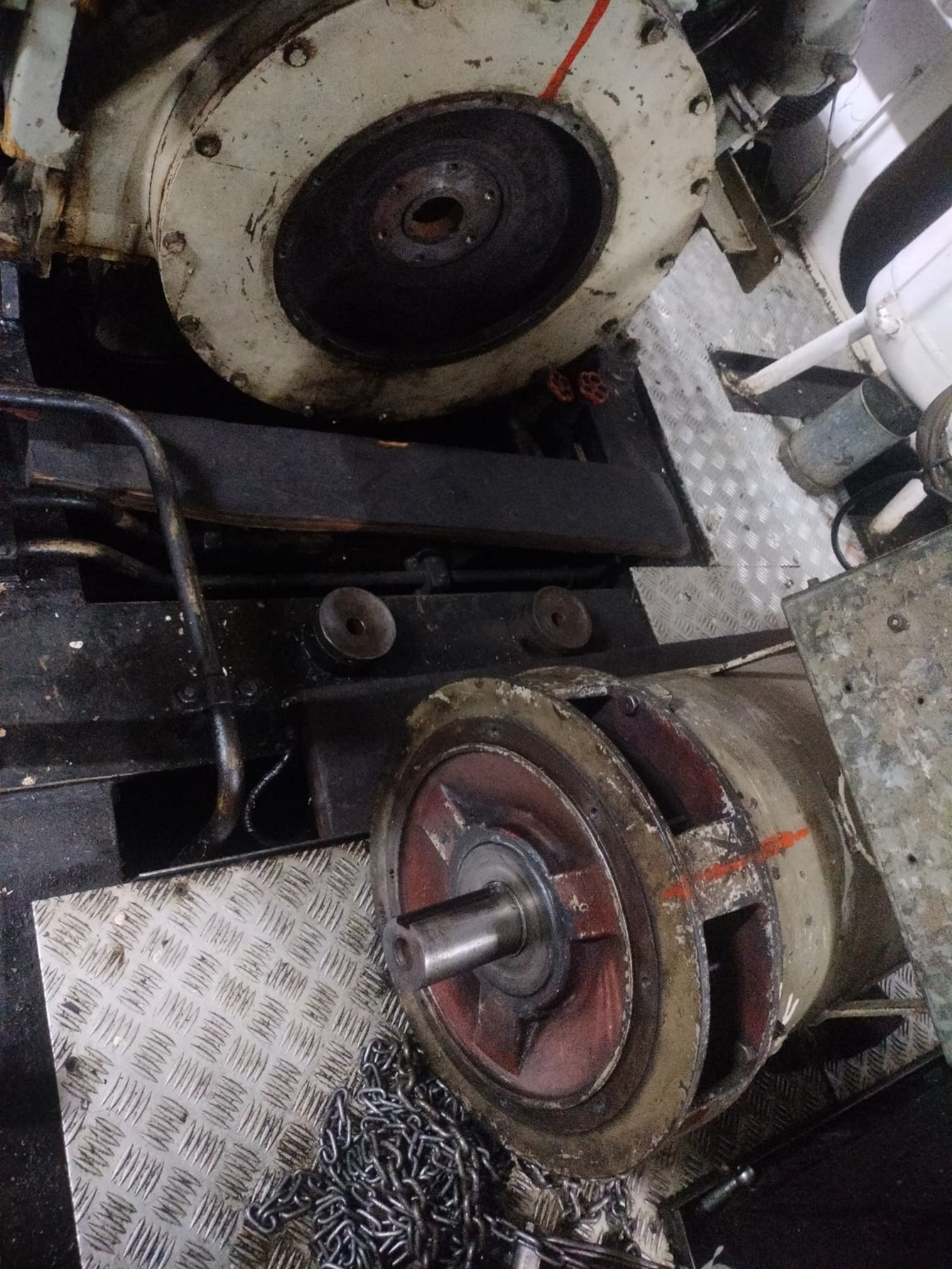





AUX. ENGINE

CAT®		3412	
SER. NO.	60M03303	DATE DELIVERED	
MODIFICATION NO.		DLR CODE	
AR NO.	2W0161	PERF SPEC	014053
OEM NO.		MAX ALT	2000M
FULL LOAD STATIC FUEL	2.24 MM	FULL TORQ. STATIC FUEL	
POWER	413 HP	A/F RATIO	
BARE ENG. HI IDLE RPM	1543	DYNAMIC FUEL TIMING	300 BTC
FULL LOAD RPM	1500		

4W5140 4



aux. engine. alternater

