



Phone :- 0484 - 2389804, 2389445
E-mail :- dirkoc.iwai@nic.in
Website :- www.iwai.nic.in



भारत सरकार
GOVT. OF INDIA
पत्तन, पोत परिवहन और जलमार्ग मंत्रालय
Ministry of Ports, Shipping & Waterways
भारतीय अन्तर्देशीय जलमार्ग प्राधिकरण
INLAND WATERWAYS AUTHORITY OF INDIA
National Waterway Road, Kannadikkadu, Maradu, Ernakulam - 682 304

No: IWAI/COCH/TECH/61(A)/2024-25/56

Date: 13th September 2024

NOTICE INVITING QUOTATION

Inland Waterways Authority of India invites sealed quotations for "Construction / Fabrication of Toilet to Director's Room at Regional Office, IWAI Kochi." from reputed manufacturer / fabricator / Contractor having experience in work of below mentioned items. The details of work are as follows.

Sl. No	Item Description	Estimated Cost (Excl. GST & Incl. Labour welfare cess)	EMD	Work completion period
1	Construction / Fabrication of Toilet to Director's Room at Regional Office, IWAI Kochi.	1,39,987/-	2,800/-	45 days

Terms & Conditions:

1. The estimated cost for the mentioned work is **Rs. 1,39,987/-** (excluding GST & Inc. Labour welfare cess @ 1%) including transportation charges and the materials should be genuine as per specifications mentioned in B.O.Q and drawing enclosed in Annex-1 and Annex-2 respectively.
2. The work will be completed within 45 days from the date of issue of this work order.
3. The payment shall be made through PFMS within 15 days after submission of bill and certification of the work by the concerned office I/C.
4. The firm should submit self-certified copy of PAN card, registration certificate of firm, GST registration number, last year ITR along with the quotation, Bank details & Cancelled cheque where payment to be made, similar work done experience certificate.
5. Firm has to submit EMD of Rs. 2800/- through RTGS/NEFT only payable in favour of "Inland Waterways Authority of India" in the A/c no. 39360627884, State Bank of India, Vyttila Branch IFSC: SBIN0008694. The scanned copy of the RTGS/NEFT receipt with transaction ID must be enclosed along with the bid.
6. The bidder shall inspect the site prior to quote the rates and submission of quotation for the above said work.
7. The quoted price shall be excluding GST but including labour welfare cess @1%.
8. In case of delay in completion of the above work, liquidated damages will be applicable @ 1.0% per week subjected to a maximum 10% on the total value of contract.
9. 10% of bill amount (including EMD) will be withheld and will be released after completion of defect liability period of 6 months.
10. IWAI reserves the right to accept or reject any / all quotations without assigning any reason or any prior notice.

The sealed quotation should reach to IWAI, Kochi office latest by 26.9.2024 at 15.30 hrs. Any delay in receipt of quotation whatsoever will not be entertained. The received quotation will be opened on 27.9.2024 at 12.00 hrs.

Encl. 1. Annexure -1
2. Annexure -2

Copy to: 1. IWAI Website.
2. Notice Board, IWAI, Kochi Office

Yours faithfully,

(A. Selvakumar)
Director
Email: aselvakumar.iwai@nic.in
Phone: 0484-2389804

Annexure -1

Tender Inviting Authority: Inland Waterways Authority of India, Kochi	
Name of Work: NIQ for Construction / Fabrication of Toilet to Director's Room at Regional Office, IWAI Kochi	
Contract No. IWAI/COCH/TECH/61(A)/2024-25/56	
Bidder Name:	

PRICE SCHEDULE

Sl. No	Item Description	Item Code / Make	Qty	Units	Basic Price (in. Rs.)	Total Amount in Rs. (Col. 4x Col. 6)
1	2	3	4	5	6	7
1	Brick work with common burnt clay F.P.S. (non-modular) bricks of class designation 7.5 in superstructure above plinth level up to floor V level in all shapes and sizes in: Cement mortar 1:4 (1 cement: 4 coarse sand)		0.317	Cum
2	Plastering in CM 1:4, 12 mm thick on cement blocks masonry including cost of materials, labour, finishing, curing etc. complete. 12 mm cement plaster of mix: 1:4 (1 cement: 4 coarse sand)		3.960	Sqm
3	Providing and fixing 1st quality ceramic glazed wall tiles conforming to IS: 15622 (thickness to be specified by the manufacturer), of approved make, in all colours, shades except burgundy, bottle green, black of any size as approved by Engineer-in-Charge, in skirting, risers of steps and dados, over 12 mm thick bed of cement mortar 1:3 (1 cement : 3 coarse sand) and jointing with grey cement slurry @ 3.3kg per sqm, including pointing in white cement mixed with pigment of matching shade complete.	Kajaria / cera / Johnson	2.520	Sqm
4	Providing and fixing aluminium work for doors, windows, ventilators and partitions with extruded built up standard tubular sections/ appropriate Z sections and other sections of approved make conforming to IS: 733 and IS: 1285, fixing with dash fasteners of required dia and size, including necessary filling up the gaps at junctions, i.e. at top, bottom and sides with required EPDM rubber/ neoprene gasket etc. Aluminium sections shall be smooth, rust free, straight, mitred and jointed mechanically wherever required including cleat angle, Aluminium snap beading for glazing / paneling, C.P. brass / stainless steel screws, all complete as per architectural drawings and the directions of Engineer-in-charge. (Glazing, paneling and dash fasteners to be paid for separately) For fixed portion. Powder coated aluminium.		44.800	Kgs
5	Providing and fixing machine moulded aluminium covering of approved pattern & design, made out of machine cut aluminium sheet and machine holed for receiving dash fastener, over expansion joints on vertical surfaces/ceiling floors, the fixing on plate in one row on one side of joint only shall be done with stainless steel dash fasteners of 8 mm dia and 75 mm long bolt including providing aluminium washers		31.752	Kgs

13/6/24
DR

	2 mm thick & 15 mm dia, at a staggered pitch of 200mm centre to centre including drilling holes in the receiving surface and providing expandable plastic sleeves in holes etc. complete as per direction of Engineer-in-charge. Anodized aluminium sheet 0.9 mm thick (anodized transparent or dyed to required shade according to IS: 1868, Minimum anodic coating of grade AC 15)					
6	Providing and fixing glazing in aluminium door, window, ventilator shutters and partitions etc. with EPDM rubber / neoprene gasket etc. complete as per the architectural drawings and the directions of engineer-in-charge. (Cost of aluminium snap beading shall be paid in basic item): With float glass panes of 4.0 mm thickness (weight not less than 10kg/sqm)		1.350	Sqm
7	Filling the gap in between aluminium frame & adjacent RCC / Brick / Stone work by providing weather silicon sealant over backer rod of approved quality as per architectural drawings and direction of Engineer-in-charge complete. Up to 5mm depth and 5 mm width.		8.400	RM
8	Providing and fixing factory made P.V.C. door frame of size 50x47 mm with awall thickness of 5 mm, made out of extruded 5mm rigid PVC foam sheet, mitred at corners and joined with 2 Nos of 150 mm long brackets of 15x15 mm M.S. square tube, the vertical door frame profiles to be reinforced with 19x19 mm M.S. square tube of 19-gauge, EPDM rubber gasket weather seal to be provided throughout the frame. The door frame to be fixed to the wall using M.S. screws of 65/100 mm size, complete as per manufacturer's specification and direction of Engineer in-Charge.		5.800	RM
9	Providing and fixing factory-made panel PVC door shutter consisting of frame made out of M.S. tubes of 19-gauge thickness and size of 19 mm x 19 mm for styles and 15x15 mm for top & bottom rails. M.S. frame shall have a coat of steel primers of approved make and manufacture. M.S. frame covered with 5 mm thick heat moulded PVC 'C' channel of size 30 mm thickness, 70 mm width out of which 50 mm shall be flat and 20 mm shall be tapered in 45 degree angle on both side forming styles and 5 mm thick, 95 mm wide PVC sheet out of which 75mm shall be flat and 20 mm shall be tapered in 45 degree on the inner side to form top and bottom rail and 115 mm wide PVC sheet out of which 75 mm shall be flat and 20 mm shall be tapered on both sides to form lock rail. Top, bottom and lock rails shall be provided both side of the panel. 10 mm (5 mm x 2) thick, 20 mm wide cross PVC sheet be provided as gap insert for top rail & bottom rail, paneling of 5 mm thick both side PVC sheet to be fitted in the M.S. frame welded/ sealed to the styles & rails with 7 mm (5 mm+2 mm) thick x 15 mm wide PVC sheet beading on inner side, and joined together with solvent cement adhesive. An additional 5 mm thick PVC strip of 20 mm width is to be stuck on the interior side of the 'C' Channel using PVC solvent adhesive etc. complete as per direction of Engineer-in-charge, manufacturer's specification & drawing. using 30 mm thick pre laminated PVC door shutters		1.800	sqm

Handwritten signature

10	Providing and fixing wash basin with C.I. brackets, 15 mm C.P. brass pillar taps, 32 mm C.P. brass waste of standard pattern, including painting of fittings and brackets, cutting and making good the walls wherever require. White Vitreous China Flat back wash basin size 450x 300 mm with single 15mm C.P. brass pillar tap.	Jaguar / Kohler / Hindware / Cera	1.000	Nos
11	Providing and fixing 8 mm dia C.P./ S.S. Jet / Health faucet with flexible tube up to 1 metre long with S.S. triangular plate/wall mount holder to European type W.C. of quality and make as approved by Engineer - in - charge.	Jaguar / Kohler / Hindware / Cera	1.000	Nos
12	Providing and fixing white vitreous china extended wall mounting water closet of size 780x370x690 mm of approved shape including providing & fixing white vitreous china cistern with dual flush fitting, of flushing capacity 3 litre / 6 litre (adjustable to 4 litre / 8 litres), including seat cover, and cistern fittings, nuts, bolts and gasket etc. complete.	Jaguar / Kohler / Hindware / Cera	1.000	Nos
13	Demolishing brick work manually / by mechanical means including stacking of serviceable material and disposal of unserviceable material within 50 metres lead as per direction of Engineer-in-charge. In cement mortar.		0.420	Cum
14	Dismantling C.I./PVC or asbestos water pipe with fittings and clamps including stacking the material within 50 metres lead and up to 110 mm dia pipe		6.500	RM
15	Dismantling of wash basin / flushing cistern of all types (C.I. / PVC / Vitrious China) including stacking of useful materials near the site and disposal of unserviceable materials within 50 metres		1.000	Nos
16	Repairs to plaster of thickness 12 mm to 20 mm in patches of area 2.5 sq.meters and under, including cutting the patch in proper shape, raking out joints and preparing and plastering the surface of the walls complete, including disposal of rubbish to the dumping ground, all complete as per direction of Engineer-in-Charge. With cement mortar 1:4 (1 cement: 4 fine sand)		3.600	Sqm
17	Making the opening in brick masonry including dismantling in floor or walls by cutting masonry and making good the damages to walls, flooring and jambs complete, to match existing surface i/c disposal of mulba / rubbish to the nearest municipal dumping ground, all complete as per direction of Engineer-in-Charge. For door/ window/ clerestory window.		2.000	Sqm
18	Applying one coat of water thinnable cement primer of approved brand and manufacture on wall surface. Water thinnable cement primer		3.600	Sqm
19	Wall painting with acrylic emulsion paint of approved brand and manufacture to give an even shade: Two or more coats on new work.	Asian paints / Berger /	3.600	Sqm
20	Providing and laying Ceramic glazed floor / wall tiles of size 300x300 mm (thickness to be specified by the manufacturer) of 1st quality conforming to IS: 15622 of approved make in colours such as White, Ivory, Grey, Fume Red Brown, laid on 20 mm thick cement mortar 1:4 (1 Cement: 4 Coarse sand), Jointing with grey cement slurry @ 3.3 kg/sqm including pointing the joints with white cement and matching pigment etc., complete.		1.380	Sqm

21	Providing and fixing PVC pipes, including all PVC plain & threaded fittings This includes jointing of pipes & fittings with solvent cement, and the cost of cutting chases and making good the same including testing of joints complete as per direction of Engineer-in-charge: Concealed work including cutting chases and making good the walls etc: 20 mm nominal outer dia pipes.	Supreme / Finolex. / Astral or Equivalent	0.400	RM
22	Providing and fixing PVC pipes, including all PVC plain & threaded fittings This includes jointing of pipes & fittings with solvent cement, and the cost of cutting chases and making good the same including testing of joints complete as per direction of Engineer-in-charge: Concealed work including cutting chases and making good the walls etc: 63 mm nominal outer dia pipes.		0.400	RM
23	Providing and fixing PVC pipes, including all PVC plain & threaded fittings This includes jointing of pipes & fittings with solvent cement, and the cost of cutting chases and making good the same including testing of joints complete as per direction of Engineer-in-charge: Concealed work including cutting chases and making good the walls etc: 110 mm nominal outer dia pipes.		0.300	RM
24	Providing and fixing PVC pipes, including all PVC plain & threaded fittings This includes jointing of pipes & fittings with solvent cement, and clamps, i/c cutting and making good the walls etc. including testing of joints complete as per direction of Engineer-in-charge: External work - Exposed on wall: 20 mm dia nominal bore.		4.800	RM
25	Providing and fixing PVC pipes, including all PVC plain & threaded fittings This includes jointing of pipes & fittings with solvent cement, and clamps, i/c cutting and making good the walls etc. including testing of joints complete as per direction of Engineer-in-charge: External work - Exposed on wall: 63 mm dia nominal bore.		7.300	RM
26	Providing and fixing PVC pipes, including all PVC plain & threaded fittings This includes jointing of pipes & fittings with solvent cement, and clamps, i/c cutting and making good the walls etc. including testing of joints complete as per direction of Engineer-in-charge: external work - Exposed on wall: 110 mm dia nominal bore.		3.300	RM
27	Providing, installation, commissioning etc. of exhaust fan of size 200mm with all fittings, connections including switches etc, making holes in existing truss/partition/wall etc. Complete as per direction of Engineer-in-charge.		1.000	Nos
Total Amount in Rs.					

Signature and seal of contractor

gh
16/7/20

Plan: Toilet to Director's room at RO, Kochi

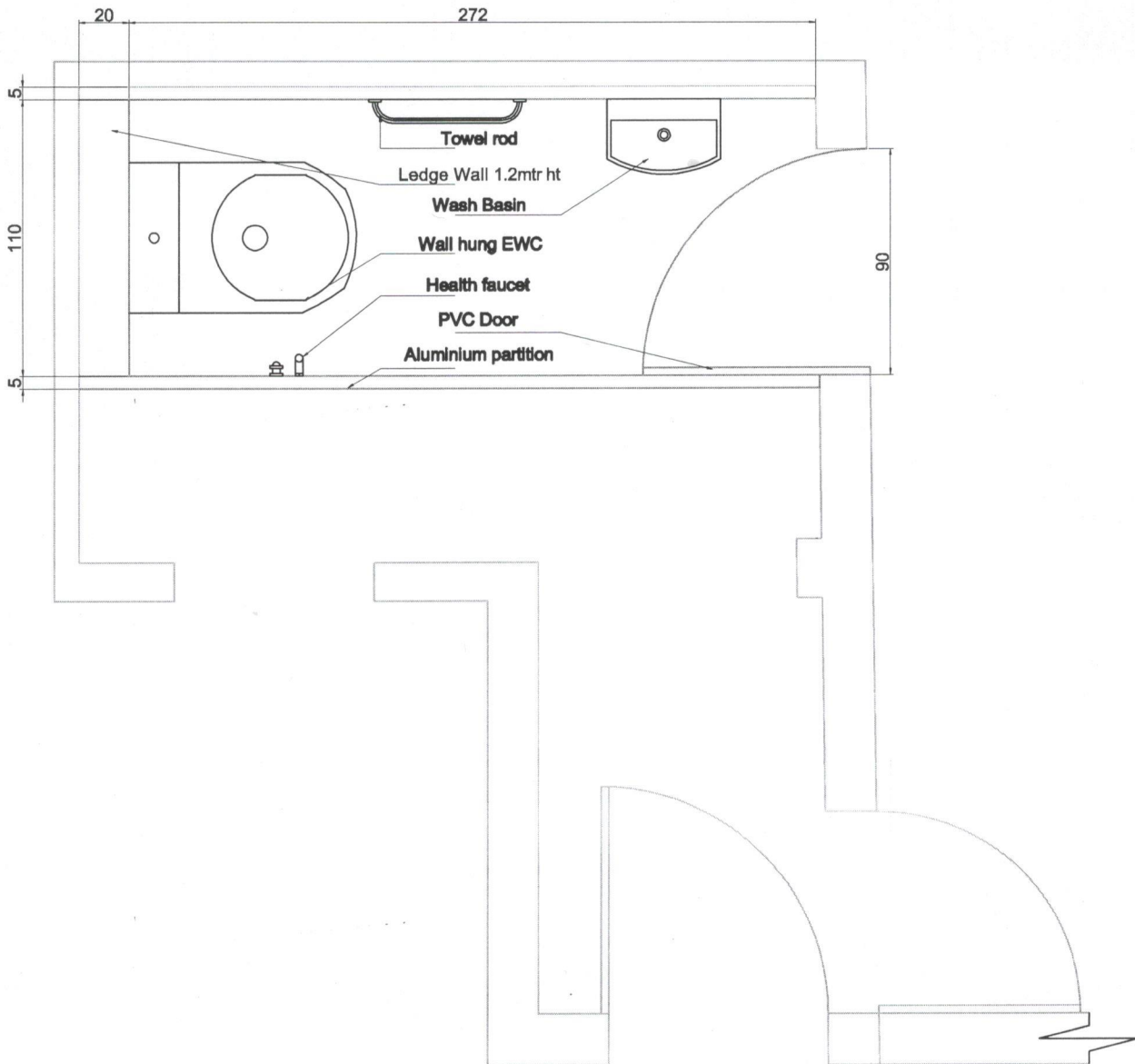

Notes:

1. All dimensions are in centimetres unless otherwise specified.
2. Green lines denote existing walls.
3. Red and black lines denote new construction / fabrication / fittings etc.
4. The above drawing is for information only and may change as per site condition or direction of Engineer-in-charge.

Handwritten signature and date:
13/9/14
W/S